

Glenarm Walk

BRISLINGTON

APPROXIMATE FLOOR AREA
85.5 SQM / 921 SQFT



GROUND FLOOR
450 sq.ft. (41.8 sq.m.) approx.

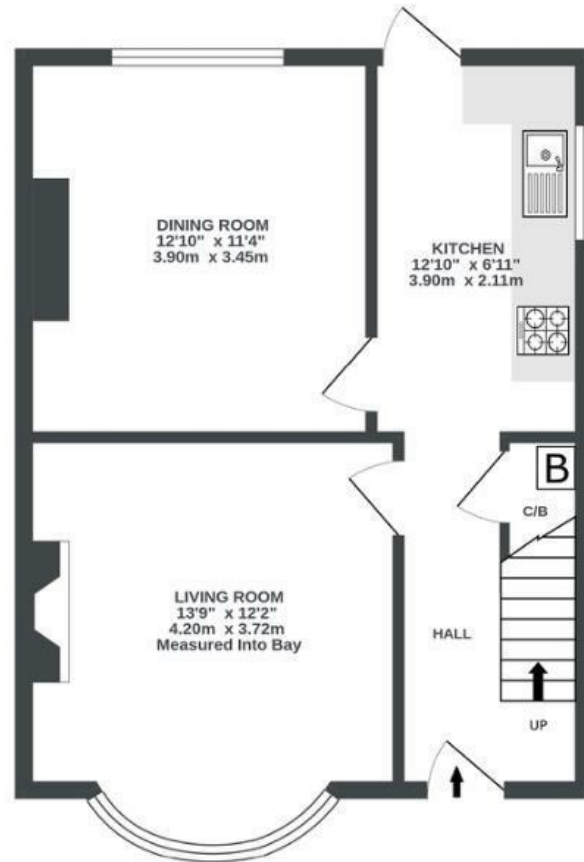

1ST FLOOR
470 sq.ft. (43.7 sq.m.) approx.

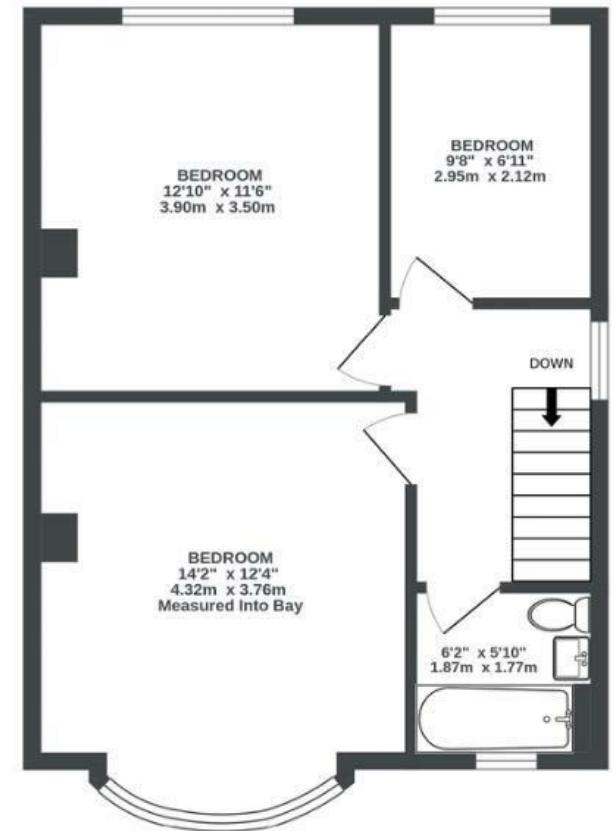

Illustrations are for reference purposes only, measurements are approximate, not to scale.

Boardwalk

Glenarm Walk

BRISLINGTON, BRISTOL



£400,000



3 Bedrooms



BS4 4LS



1 Bathrooms

"I have really enjoyed having such a large sunny garden and the light and bright rooms. It's only a short walk to Sandy Park road with the independent cafes and shops like Kin and The Deli and also been really easy to get to Templemeads, the City Centre. Glenarm is a really quiet street as it's a no through road which an almost village vibe."

